

# FAIRVIEW ONE STAND OFF DETAILS

Typical rebate set outs and installation details for our Fairview residential joinery suites can be found on our specification website. [www.fairviewwindowsspecifiers.co.nz/our-suites/](http://www.fairviewwindowsspecifiers.co.nz/our-suites/)

On the following pages are the Fairview One installation details for common cladding types. Please contact your local Fairview Fabricator for assistance if you require installation information for other claddings.

## CAVITY CONSTRUCTION

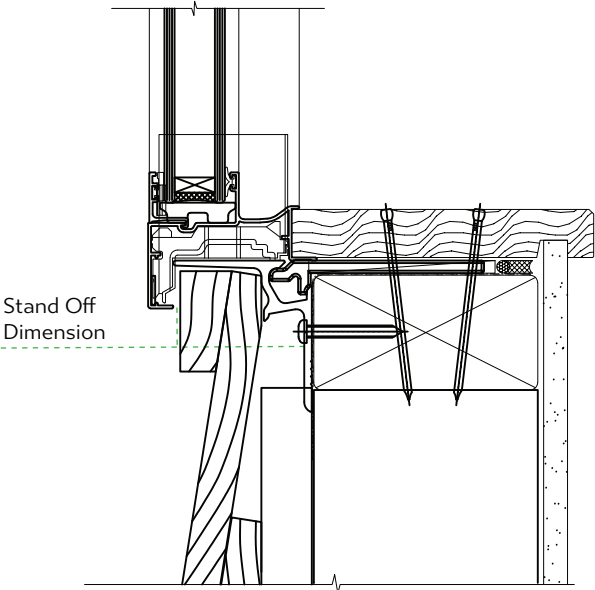

## DIRECT FIX CONSTRUCTION

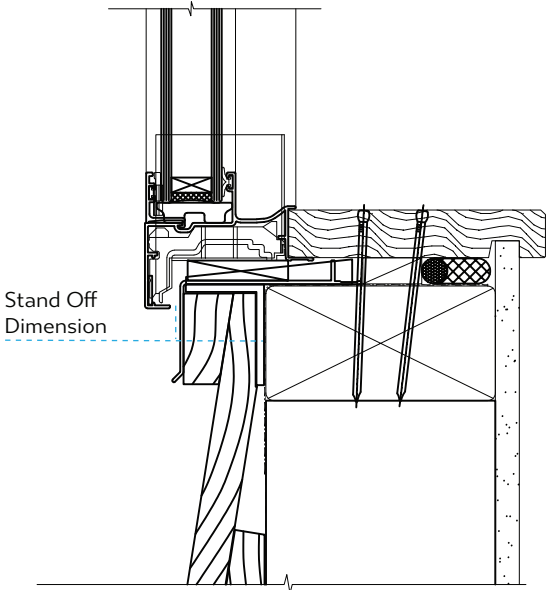

### TYPICAL STAND OFF DIMENSION

CLADDING	CAVITY CONSTRUCTION	DIRECT FIX CONSTRUCTION
BEVEL BACK WEATHERBOARD	56mm	38mm
RUSTICATED WEATHERBOARD	44mm	26mm
FIBRE CEMENT SHEET	33mm	15mm
FIBRE CEMENT WEATHERBOARD	43mm	25mm
PLYWOOD SHEET	38mm	20mm
VERTICAL PROFILE METAL	-----	9mm
HORIZONTAL PROFILE METAL	29mm	-----
BRICK VENEER	62mm	-----
EIFS RECESSED	25mm	-----
STUCCO RECESSED	26mm	-----

### NOTES

- The stand off dimension is from the framing to the back of the joinery flange.
- These are typical dimensions and based off standard best practice install details.
- A 18-20mm batten is allowed for in the Cavity details.
- A 5mm stand off from the cladding is allowed for on Direct Fix.
- Plywood Sheet is based on 12mm Ply.
- Brick Veneer dimension puts the windows approximately 13mm onto the brick.