

## FAIRVIEW ONE REBATE DETAILS

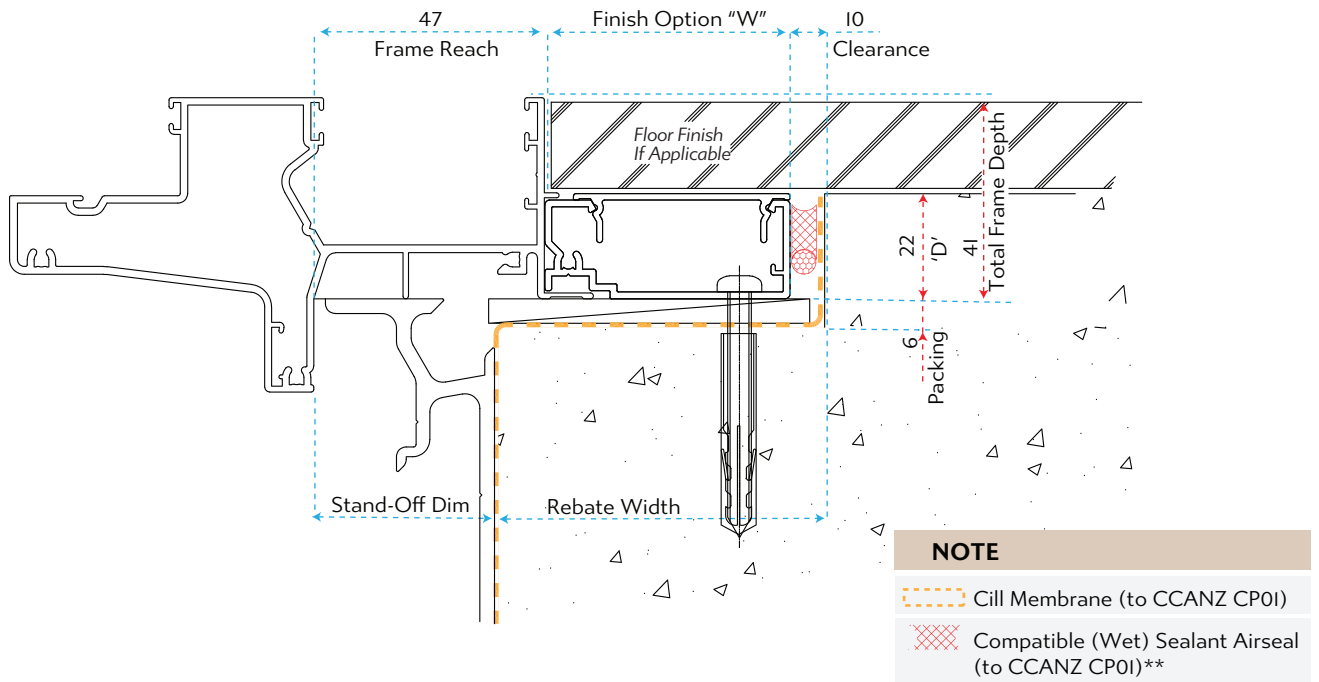

### REBATE WIDTH CALCULATION SHEET

	FRAME REACH (W)	+	FINISHING OPTION	+	CLEARANCE 10MM	-	STAND OFF	=	REBATE WIDTH
AWNING WINDOW	47	+		+	10mm	-		=	
HINGED DOOR	74	+		+	10mm	-		=	
PROJECTED SLIDING DOOR	47	+		+	10mm	-		=	
PROJECTED STACKING DOOR	99	+		+	10mm	-		=	
FLAT SLIDING DOOR	99	+		+	10mm	-		=	
FLAT STACKING DOOR	148	+		+	10mm	-		=	

### REBATE DEPTH CALCULATION SHEET

	PACKING CLEARANCE	+	PLUS FINISHING TYPE (D)	OR	TOTAL FRAME DEPTH	-	LESS FLOOR FINISHING	=	REBATE DEPTH
AWNING WINDOW	6	+	22	or	35	-		=	
HINGED DOOR	6	+	22	or	53	-		=	
PROJECTED SLIDING DOOR	6	+	22	or	41	-		=	
PROJECTED STACKING DOOR	6	+	22	or	41	-		=	
FLAT SLIDING DOOR	6	+	22	or	41	-		=	
FLAT STACKING DOOR *	6	+	22	or	41	-		=	

**Noted:** The above calculation sheet has been created as a guide only and should not be treated as a substitute for technical advice in relation to individual circumstances. Please talk to your local Fairview Fabricator for more information and assistance.

\* Flat Stacking door may require your wall to be "packed" if using 90mm framing.

\*\* Airseal, wetseal + cill membrane to operate as a "complete system". For further information please refer to your current sealant supplier, or visit [www.fairviewwindowspecifiers.co.nz](http://www.fairviewwindowspecifiers.co.nz).